

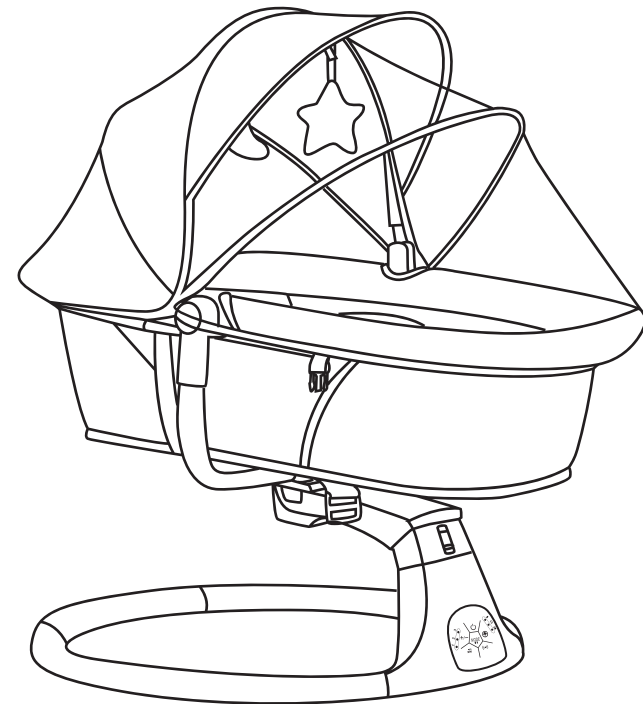

Momushk[®]
MSK 016

Multi-Functional Baby Swing



Please read this manual carefully before install and use,
otherwise it may affect the safety of children

content

一、 Content	1
二、 Product Specifications	2
三、 To know the product	3
Product List	3
product structure	3
cleaning and washing	4
Assembly details	4
safety instructions	5
Product power	5
四、 The use of products	6
function usage	6
Remote Control Instructions	7
Panel Description	7
五、 Notice	8
六、 After-sales service	9

After-sales service card

Thank you for purchasing our company's products. For your rights and interests, please keep the after-sales service card properly. If you have any product quality problems, please contact the dealers.

name		phone	
product name			
purchase date			
address			

Notice

- From the date of purchase, for normal users, the circuit board parts enjoy one year of free maintenance service, and the whole machine enjoys one year of free maintenance service. The product outside plastic is not covered by the warranty.
- Other consumables and accessories are not covered by the warranty;
- Please show the after-sales service card and purchase proof or invoice to be valid when repairing.

Non-warranty coverage

- Incorrect use and human-induced damage
- Lost or damaged after-sale service card
- Damaged due to force majeure such as natural disasters

Thank you for using this product. We are committed to serving consumers with better products, more thoughtful service and more favorable prices. Our company has more products for you to choose!

Product Specifications

Product name	Multi-Functional Baby Swing
Input voltage	100-240V-50/60Hz
Output voltage	DC5V、 1A
Applicable age	0-12 months, weighing less than 9 kg
Production date	marked on the packaging or product
Warning	Do not use adapters of non-standard classes

Notice

- 1) The power terminals must not be short-circuited
- 2) Do not use adapters of non-standard classes to power the product.
The input power of the adapter is 100-240V~50/60Hz.
The output voltage and electric current are DC5V, 1A.
- 3) When using the adapter, keep the adapter away from children
- 4) Adapters used for swings should be regularly inspected for power cord sockets, accessories and other parts, and should be stop using if there is any damage.

Product List

Please check the quantity of the contents before using, if there are any missing parts, please contact the seller.

Number	①	②	③	④	⑤	⑥	⑦
Name	Long Pipe	Short Pipe	hosts	connection	cabin	awning	accessory kit
Amount	2	1	1	1	1	1	1

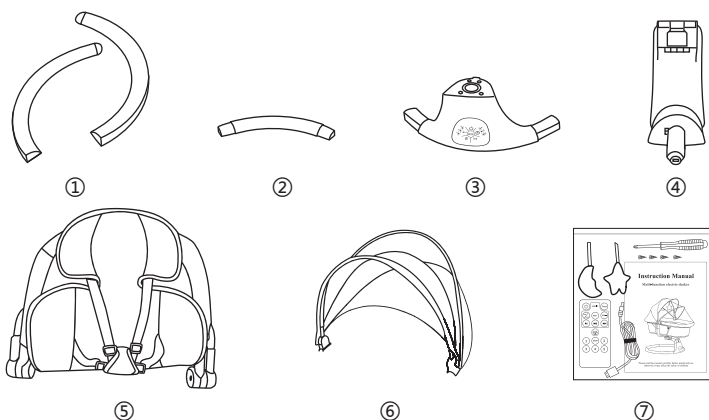

Warning ! This product should only be assembled and cleaned by adults

Cleaning and washing

Seat frame set: Remove the seat frame set; washed by hand in cold water.

Toys: Hand and machine washable; soaked in water and added with soft detergent, scrubbed by a soft brush; filtered and dehydrated with clean water, or directly put into the washing machine for washing and dehydration, and put them in a cool place to dry.

Fabric: Flannel, hand and machine washable.

Inner filling: Fire-resistant rigid resin cotton.

warning! Bleaching, dehydration, drying are prohibited!

Warning

1. Must use seat belt when using this product!
2. Do not leave unattended children alone in the product
3. Suitable age: 0-12 months, weighing less than 9 kg
4. Do not use toy sticks to pick up or move it.
5. Do not lift or move this product when children are in it
6. It is strictly forbidden to put other things on the toy stick except for the matching toys!
7. This product is strictly prohibited to be used in high places (such as: countertops, tables, stairs or other places higher from the ground) to prevent the danger of falling!
8. When using this product, please place this product on a flat surface, and it is not allowed to use it on a non-flat surface!
9. Pay attention to the danger of asphyxia : Please do not use it on soft objects to prevent asphyxia (such as beds, sofas, etc.)
10. Please do not use it for the baby who can sit up alone to prevent hidden accidents such as choked or strangled by a seat belt
11. Do not let children use this product as a toy!
12. This product should not be opened or folded until children are away from it!
13. This product can be used for a long time.
14. When this product is connected to a music player, make sure that the volume of the player is setting to the low level!
15. If any part is damaged or missing, please do not use this product unless a replacement part has been reviewed by the manufacturer, do not use a substitute easily !
16. Stay away from fire!
17. The bassinet can only be used when the locking mechanism of the folding system is engaged.

Remote Control Instructions

	Power switch button		Play / Pause
	Timing setting		Previous song
	Usb/music		Next song
	Volume increase		Motion control
	Volume down		Stop

					Swing, five gears
--	--	--	--	--	-------------------

Panel Description

	Switch
	Swing gear adjustment
	Built-in music and Bluetooth switch
	Timing button
	Motion control button
	Music switching, volume level

Product Installation

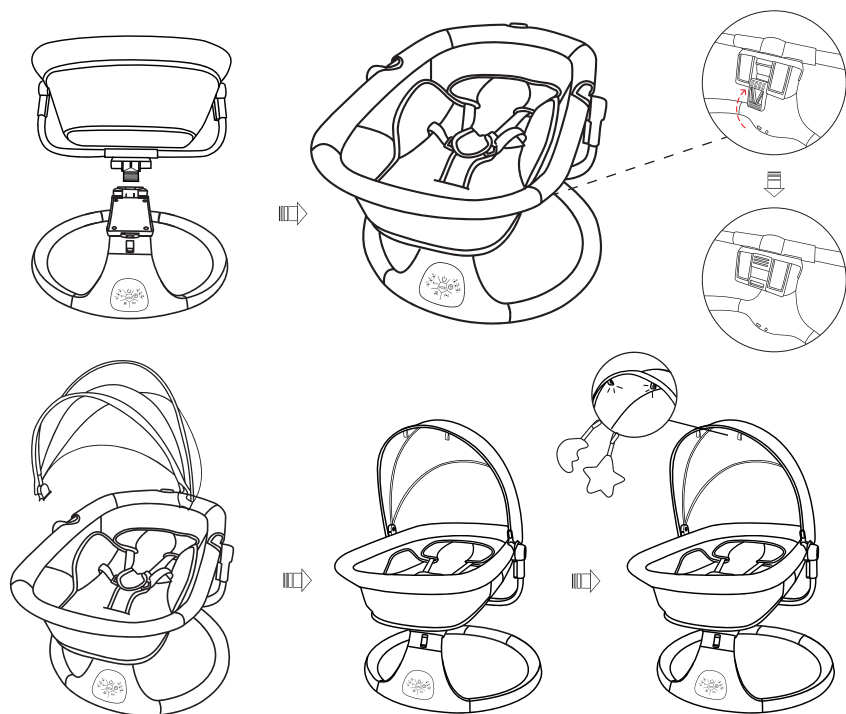

Product power

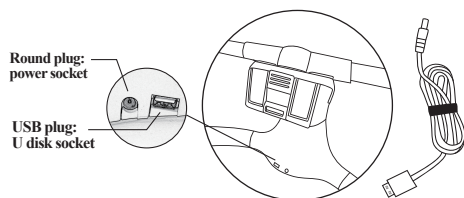

1. The DC plug can be inserted into the AC power supply of 100-240V-50/60Hz
2. The DC connector can be connected to the power bank for power supply
3. Adapter output parameters: voltage is 5V, electric current is 1A. Do not use adapters of non-standard classes to power the product.

function usage

- (1) **Power switch button:**
 1. Press the first time, the indicator light is on, the power is turned on
 2. Press the second time, the indicator light is off, and the power is cut off.
- (2) **Gear increase/decrease button:**

There are 5 kinds of swing options in the gear adjustment, and the adjustment starts from the stop gear to increase, and the current gear is relative to the on and off of the gear indicator light.

The swing angle is about 0°, 18°, 21°, 23°, 25°, 31° (no load) in turn, load will be slightly reduced

Note:

 1. When the gear is in neutral and there is no timing, the gear indicator light and timing light will flash;
 2. When a jam is detected, the gear will be automatically closed, and the gear indicator light will flash to remind
- (3) **Timing button:**

Press the first indicator light is on for 8 minutes
 Press the second indicator light twice is on for 15 minutes
 Press the third indicator light three times is on for 30 minutes

All functions stop when the timer time is up and enter the standby power saving mode;
 If you do not start the timer function, the other functions started will work for 1 hour to automatically shut down;
- (4) **Music play volume buttons:**

Short press first time to play music, short press second time for next song.
 Short press third time next song cycle; long press to hear the volume change and let go to adjust the volume cycle; super long press 5s to turn off the music. change let go can cycle adjust the volume, super long press 5s off the music
- (5) **Motion control button:**

Short press to enter the motion control mode, automatically start the 1-speed rocking, timed at 8 minutes, 8 minutes to the After that, the rocking stops and returns to (to be sensed state), when the cradle is detected to be shaking again, it will start the 1-speed rocking again, timed for 8 minutes and so on;
- (6) **Bluetooth connection:**

Turn on the mobile phone Bluetooth to connect "S0008", after the connection is successful, you can directly play the song.
- (7) **MODE button:**

The MODE button is the switch button for internal music and USB or Bluetooth. The button is invalid when there is no USB and Bluetooth:
- (8) **If the rocking chair shakes badly, please check if the machine is placed on the flat.**